

# HAM-LET PRECISION INSTRUMENT PIPE FITTINGS **PIPELINE**



**GENERAL**

The HAM-LET® Group Ltd. is pleased to introduce our line of Precision Instrument Pipe Fittings.

The Pipeline range of connectors is manufactured for typical applications in chemical and petrochemical processing plants, as well as oil, gas and power generation industries. This fully illustrated catalog contains detailed engineering information, dimensional data and the part numbering system.

**FEATURES**

- Sizes range from 1/8" to 1".
- Fittings are properly packaged with the exposed threads protected to ensure they are not damaged during delivery.
- All pipe threads meet the requirements of **ASME/ANSI B1.20.1** (1983) for tapered pipe threads (NPT).
- Working pressures calculated in accordance with Power Piping Code **ANSI B 31.1**, Refiner Piping Code **ASME/ANSI B 31.3** and section VIII of **ASME** Boiler & Pressure Vessel Code.

PRESSURE RATINGS (PSI)					
NPT or BSPT/ISO size		316 Stainless Steel		Brass	
in	male	female	male	female	female
1/8	9400	6100	5000	3200	
1/4	7500	6200	4000	3300	
3/8	7300	5000	3900	2600	
1/2	7200	4600	3800	2400	
3/4	6800	4300	3600	2300	
1	5000	4100	2600	2200	

MATERIALS			
Materials	Specification		
	Barstock	Forgings	
316 Stainless Steel	ASTM A-276	ASTM A-182	
	ASTM A-479		
Brass	ASTM B-453	ASME B-283	
	ASTM B-16 DIN 176.60		

**INSTALLATION INSTRUCTIONS**

To ensure a leak-tight seal, HAM-LET® recommends the use of a pipe thread sealant on all NPT threads. The most effective sealing method is teflon tape. Tape should be used only on male tapered pipe threads.

**Do not use tape on flared, coned or tube fitting ends!**

Clean both male and female tapered threads. Wrap tape in the direction of the male tapered thread spiral.

**Note:** Two wraps are suggested for stainless steel tapered pipe threads. Make sure tape does not overhang the first thread, as the tape might shred and enter the fluid system. Cut off excess tape. The connection is now ready for proper makeup.

**ORDERING INFORMATION**

**EXAMPLE**

101H

1/4

└───┬───┘

|

Material Description

SS = Stainless Steel

B = Brass

All orders should include ordering information and material description.

PIPE LINE® - INDEX		
<p>ELBOW..... 3 100H</p> 	<p>HEX LONG NIPPLE..... 6 113H</p> 	<p>HEX NIPPLE..... 10 MALE NPT TO MALE BSPT 122HNR</p> 
<p>MALE ELBOW..... 3 100HM</p> 	<p>STREET ELBOW..... 7 116H</p> 	<p>HEX NIPPLE..... 11 Male NPT to Male BSPP 122HNG</p> 
<p>TEE..... 3 101H</p> 	<p>HEX REDUCING COUPLING..... 7 119H</p> 	<p>REDUCING NIPPLE..... 11 123H</p> 
<p>MALE TEE..... 4 101HM</p> 	<p>ADAPTER NPT..... 8 120H</p> 	<p>BRANCH TEE..... 11 3600H</p> 
<p>CROSS..... 4 102H</p> 	<p>ADAPTER..... 8 NPT FEMALE TO MALE BSPT 120HNR</p> 	<p>STREET TEE..... 12 3750H</p> 
<p>HEX COUPLING..... 4 103H</p> 	<p>ADAPTER..... 9 FEMALE NPT TO MALE BSPP 120HNG</p> 	<p>MALE HOSE CONNECTOR..... 12 130HM</p> 
<p>UNION RECORD..... 5 104H</p> 	<p>ADAPTER..... 9 FEMALE BSPT TO MALE NPT 120HRN</p> 	<p>FEMALE HOSE CONNECTOR..... 13 130HF</p> 
<p>HOLLOW HEX PLUGS..... 5 107H</p> 	<p>GAUGE ADAPTER..... 9 FEMALE BSPP TO MALE NPT 120HGN</p> 	<p>TUBE TO HOSE CONNECTOR..... 13 130LT</p> 
<p>PIPE CAP..... 5 108H</p> 	<p>PIPE PLUG NPT..... 10 121H</p> 	
<p>REDUCING BUSHING..... 6 110H</p> 	<p>HEX NIPPLE..... 10 122H</p> 	

100 H  
ELBOW

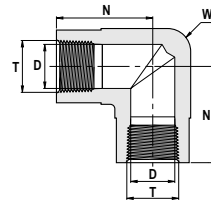

Ordering Information	T Female NPT Size	N		D Min. Opening		W Wrench Flat
		in	mm	in	mm	in
		100H_ 1/8	1/8	1.04	26.4	0.34
100H_ 1/4	1/4	1.17	29.7	0.45	11.4	13/16
100H_ 3/8	3/8	1.42	36.1	0.59	15.0	15/16
100H_ 1/2	1/2	1.56	39.6	0.73	18.5	1 1/8
100H_ 3/4	3/4	1.92	48.8	0.94	23.9	1 3/8
100H_ 1	1	1.91	48.5	1.17	29.7	1 11/16

100 HM  
MALE ELBOW

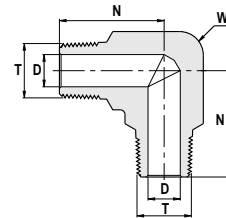

Ordering Information	T Male NPT Size	N		D Min. Opening		W Wrench Flat
		in	mm	in	mm	in
		100HM_ 1/8	1/8	0.88	22.4	0.19
100HM_ 1/4	1/4	1.05	26.7	0.28	7.1	5/8
100HM_ 3/8	3/8	1.17	29.7	0.38	9.6	13/16
100HM_ 1/2	1/2	1.45	36.8	0.47	11.9	15/16

101 H  
TEE

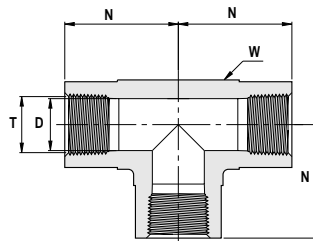

Ordering Information	T Female NPT Size	N		D Min. Opening		W Wrench Flat
		in	mm	in	mm	in
		101H_ 1/8	1/8	1.04	26.4	0.34
101H_ 1/4	1/4	1.17	29.7	0.45	11.4	13/16
101H_ 3/8	3/8	1.42	36.1	0.59	15.0	15/16
101H_ 1/2	1/2	1.56	39.6	0.73	18.5	1 1/8
101H_ 3/4	3/4	1.92	48.8	0.94	23.9	1 3/8
101H_ 1	1	1.91	48.5	1.17	29.7	1 11/16

● Dimensions are for reference only, and are subject to change without notice.

101 HM  
MALE TEE

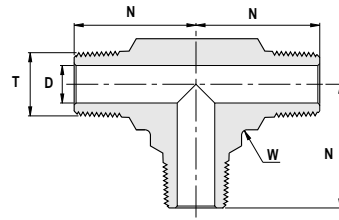

Ordering Information	T Male NPT Size	N		D Min. Opening		W Wrench Flat
		in	mm	in	mm	in
		101HM _ 1/8	1/8	0.88	22.4	0.19
101HM _ 1/4	1/4	1.05	26.7	0.28	7.1	5/8
101HM _ 3/8	3/8	1.17	29.7	0.38	9.6	13/16
101HM _ 1/2	1/2	1.45	36.8	0.47	11.9	15/16

102 H  
CROSS

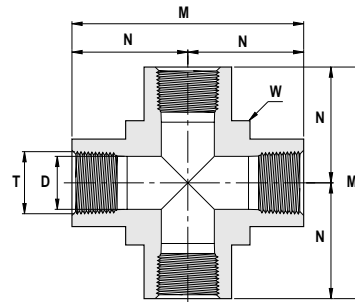

Ordering Information	T Female NPT Size	N		M		D Min. Opening		W Wrench Flat
		in	mm	in	mm	in	mm	in
		102H _ 1/8	1/8	1.04	26.4	2.08	52.8	0.34
102H _ 1/4	1/4	1.17	29.7	2.34	59.4	0.45	11.4	13/16
102H _ 3/8	3/8	1.42	36.1	2.84	72.2	0.59	15.0	15/16
102H _ 1/2	1/2	1.56	39.6	3.12	79.2	0.73	18.5	1 1/8
102H _ 3/4	3/4	1.92	48.8	3.84	97.6	0.94	23.9	1 3/8
102H _ 1	1	1.91	48.5	3.82	97.0	1.17	29.7	1 11/16

103 H  
HEX COUPLING

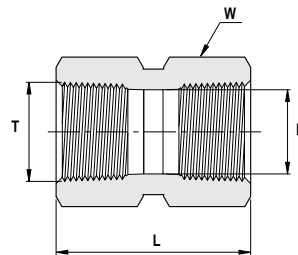

Ordering Information	T Female NPT Size	L		D Min. Opening		W Hex. Flat
		in	mm	in	mm	in
		103H _ 1/8	1/8	0.81	20.6	0.34
103H _ 1/4	1/4	1.19	30.2	0.45	11.4	3/4
103H _ 3/8	3/8	1.31	33.3	0.59	15.0	7/8
103H _ 1/2	1/2	1.56	39.6	0.73	18.5	1 1/16
103H _ 3/4	3/4	1.62	41.1	0.94	23.9	1 5/16
103H _ 1	1	2.00	50.8	1.17	29.7	1 5/8

● Dimensions are for reference only, and are subject to change without notice.

104 H  
UNION RECORD

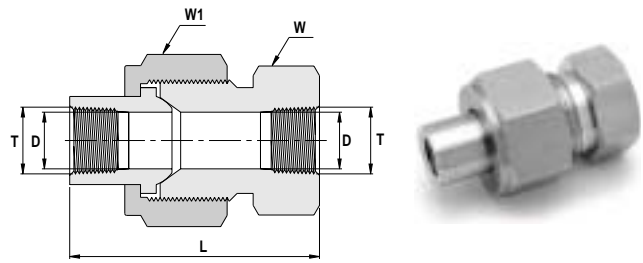

Ordering Information	T Female NPT Size	L		D Min. Opening		W Hex. Flat		W1 Hex. Flat in
		in	mm	in	mm	in	mm	
		104H _ 1/8	1/8	1.81	46.0	0.27	6.9	
104H _ 1/4	1/4	2.34	59.4	0.36	9.1	1 3/16	30.16	1 3/8
104H _ 3/8	3/8	2.50	63.5	0.52	13.2	1 5/16	33.34	1 1/2
104H _ 1/2	1/2	2.69	68.3	0.62	15.7	1 5/8	41.28	1 3/4
104H _ 3/4	3/4	3.12	79.2	0.88	22.4	1 7/8	47.63	2
104H _ 1	1	3.56	90.4	1.03	26.2	2 3/8	60.33	2 1/2

107 H  
HOLLOW HEX PLUGS

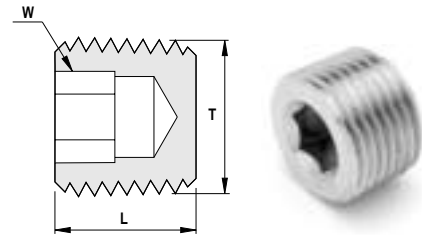

Ordering Information	T Male NPT Size	L		W Hex. Flat
		in	mm	
107H _ 1/8	1/8	0.29	7.4	3/16
107H _ 1/4	1/4	0.44	11.3	1/4
107H _ 3/8	3/8	0.44	11.3	5/16
107H _ 1/2	1/2	0.61	15.5	3/8

108 H  
PIPE CAP

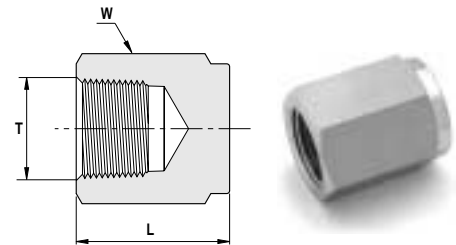

Ordering Information	T Female NPT Size	L		W Hex. Flat in
		in	mm	
108H _ 1/8	1/8	0.75	19.1	9/16
108H _ 1/4	1/4	0.91	23.1	3/4
108H _ 3/8	3/8	1.03	26.2	7/8
108H _ 1/2	1/2	1.34	34.0	1 1/16
108H _ 3/4	3/4	1.44	36.6	1 5/16
108H _ 1	1	1.62	41.1	1 5/8

● Dimensions are for reference only, and are subject to change without notice.

110 H  
REDUCING BUSHING

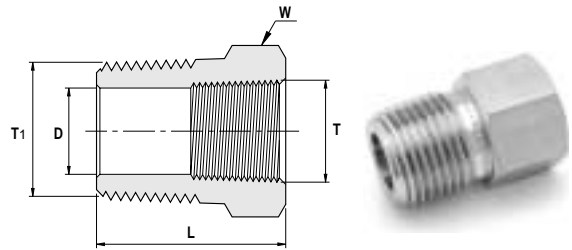

Ordering Information	T1 Male NPT Size	T Female NPT Size	L		D Min. Opening		W Hex. Flat in
			in	mm	in	mm	
110H_ 1/8 X 1/16	1/8	1/16	1.03	26.2	0.19	4.8	7/16
110H_ 1/4 X 1/8	1/4	1/8	1.06	26.9	0.28	7.1	9/16
110H_ 3/8 X 1/8	3/8	1/8	0.86	21.8	0.34	8.6	11/16
110H_ 3/8 X 1/4	3/8	1/4	1.19	30.2	0.37	9.5	3/4
110H_ 1/2 X 1/8	1/2	1/8	1.08	27.4	0.34	8.6	7/8
110H_ 1/2 X 1/4	1/2	1/4	1.08	27.4	0.45	11.4	7/8
110H_ 1/2 X 3/8	1/2	3/8	1.41	35.8	0.47	11.9	7/8
110H_ 3/4 X 1/4	3/4	1/4	1.08	27.4	0.45	11.4	1 1/16
110H_ 3/4 X 3/8	3/4	3/8	1.08	27.4	0.59	15.0	1 1/16
110H_ 3/4 X 1/2	3/4	1/2	1.63	41.4	0.62	15.7	1 1/16
110H_ 1 X 1/4	1	1/4	1.37	34.8	0.45	11.4	1 3/8
110H_ 1 X 3/8	1	3/8	1.37	34.8	0.59	15.0	1 3/8
110H_ 1 X 1/2	1	1/2	1.37	34.8	0.73	18.5	1 3/8
110H_ 1 X 3/4	1	3/4	1.85	47.0	0.88	22.4	1 3/8
110H_ 1 1/4 X 1/2	1 1/4	1/2	1.46	37.1	0.73	18.5	1 3/4
110H_ 1 1/4 X 3/4	1 1/4	3/4	1.47	37.3	0.94	23.9	1 3/4
110H_ 1 1/4 X 1	1 1/4	1	1.94	49.3	1.17	29.7	1 3/4
110H_ 1 1/2 X 1/2	1 1/2	1/2	1.61	40.9	0.73	18.5	2 1/8
110H_ 1 1/2 X 3/4	1 1/2	3/4	1.61	40.9	0.94	23.9	2 1/8
110H_ 1 1/2 X 1	1 1/2	1	1.61	40.9	1.17	29.7	2 1/8
110H_ 1 1/2 X 1 1/4	1 1/2	1 1/4	2.31	58.7	1.50	38.1	2 1/8
110H_ 2 X 1/2	2	1/2	1.83	46.5	0.73	18.5	2 3/4
110H_ 2 X 3/4	2	3/4	1.83	46.5	0.94	23.9	2 3/4
110H_ 2 X 1	2	1	1.83	46.5	1.17	29.7	2 3/4
110H_ 2 X 1 1/4	2	1 1/4	1.83	46.5	1.50	38.1	2 3/4
110H_ 2 X 1 1/2	2	1 1/2	1.83	46.5	1.73	43.9	2 3/4

113 H  
HEX LONG NIPPLE

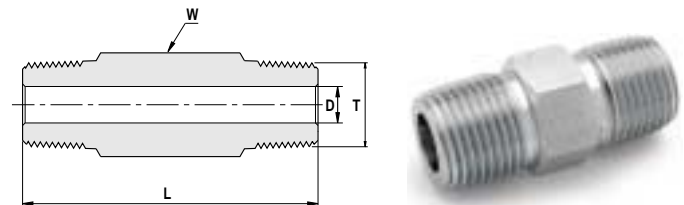

Ordering Information	T Male NPT Size	L Available Lengths (inch)					D Min. Opening		W Hex. Flat in
		1.50	2.00	2.50	3.00	4.00	in	mm	
113H_ 1/8 X 1.5 / 2 / 2.5 / 3	1/8	✓	✓	✓	✓	-	0.19	4.8	7/16
113H_ 1/4 X 1.5 / 2 / 2.5 / 3 / 4	1/4	✓	✓	✓	✓	✓	0.28	7.1	9/16
113H_ 3/8 X 1.5 / 2 / 2.5 / 3 / 4	3/8	✓	✓	✓	✓	✓	0.38	9.6	11/16
113H_ 1/2 X 2 / 3 / 4	1/2	-	✓	-	✓	✓	0.47	11.9	7/8
113H_ 3/4 X 2 / 3 / 4	3/4	-	✓	-	✓	✓	0.62	15.8	1 1/16
113H_ 1 X 3 / 4	1	-	-	-	✓	✓	0.88	22.4	1 3/8

● Dimensions are for reference only, and are subject to change without notice.

116 H  
STREET ELBOW

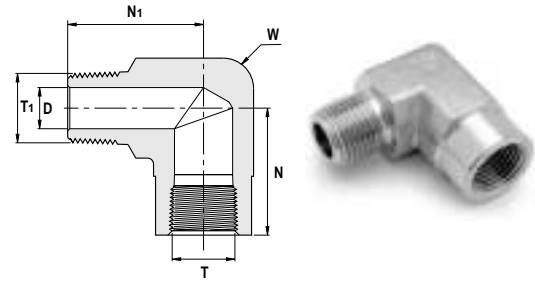

Ordering Information	T Female NPT Size	T1 Male NPT Size	N		N1		D Min. Opening		W Wrench Flat
			in	mm	in	mm	in	mm	in
			116H _ 1/16 X 1/16	1/16	1/16	0.86	21.8	0.88	22.4
116H _ 1/8 X 1/16	1/8	1/16	1.04	26.4	0.87	22.1	0.12	3.10	5/8
116H _ 1/8 X 1/8	1/8	1/8	1.04	26.4	0.87	22.1	0.19	4.80	5/8
116H _ 1/4 X 1/8	1/4	1/8	1.17	29.7	1.00	25.4	0.19	4.80	13/16
116H _ 1/4 X 1/4	1/4	1/4	1.17	29.7	1.17	29.7	0.28	7.10	13/16
116H _ 3/8 X 1/4	3/8	1/4	1.42	36.1	1.26	32.0	0.28	7.10	15/16
116H _ 3/8 X 3/8	3/8	3/8	1.42	36.1	1.26	32.0	0.38	9.60	15/16
116H _ 1/2 X 1/4	1/2	1/4	1.56	39.6	1.38	35.1	0.28	7.10	1 1/8
116H _ 1/2 X 3/8	1/2	3/8	1.56	39.6	1.38	35.1	0.38	9.60	1 1/8
116H _ 1/2 X 1/2	1/2	1/2	1.56	39.6	1.56	39.6	0.47	11.9	1 1/8
116H _ 3/4 X 3/4	3/4	3/4	1.92	48.8	1.67	42.4	0.62	15.8	1 3/8
116H _ 1 X 1	1	1	1.91	48.5	1.94	49.3	0.88	22.4	1 11/16

119 H  
HEX REDUCING COUPLING

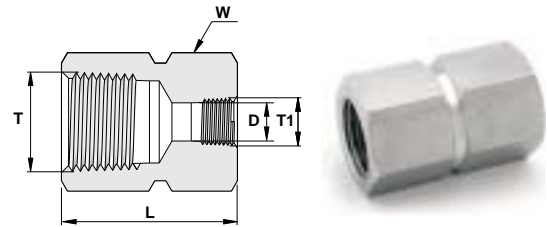

Ordering Information	T Female NPT Size	T1 Female NPT Size	L		D Min. Opening		W Hex. Flat
			in	mm	in	mm	in
			119H _ 1/4 X 1/8	1/4	1/8	1.22	31.0
119H _ 3/8 X 1/4	3/8	1/4	1.38	35.1	0.45	11.4	7/8
119H _ 1/2 X 1/8	1/2	1/8	1.56	39.6	0.34	8.6	1 1/16
119H _ 1/2 X 1/4	1/2	1/4	1.75	44.5	0.45	11.4	1 1/16
119H _ 1/2 X 3/8	1/2	3/8	1.78	45.2	0.59	15.0	1 1/16
119H _ 3/4 X 1/4	3/4	1/4	1.81	46.0	0.45	11.4	1 5/16
119H _ 3/4 X 1/2	3/4	1/2	2.06	52.3	0.73	18.5	1 5/16
119H _ 1 X 1/2	1	1/2	2.19	55.6	0.73	18.5	1 5/8
119H _ 1 X 3/4	1	3/4	2.25	57.2	0.94	23.9	1 5/8

● Dimensions are for reference only, and are subject to change without notice.



120 H  
ADAPTER NPT

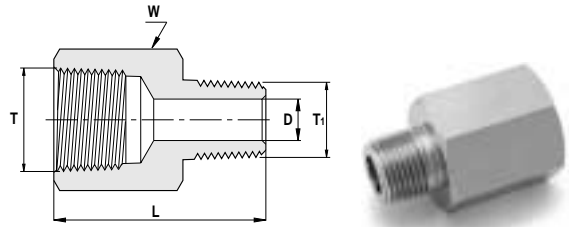

Description	T Female NPT Size	T1 Male NPT Size	L		D Min. Opening		W Hex. Flat in
			in	mm	in	mm	
120H_ 1/8 X 1/16	1/8	1/16	1.09	27.7	0.12	3.0	9/16
120H_ 1/8 X 1/8	1/8	1/8	1.10	27.9	0.19	4.8	9/16
120H_ 1/4 X 1/8	1/4	1/8	1.26	32.0	0.19	4.8	3/4
120H_ 1/4 X 1/4	1/4	1/4	1.40	35.6	0.28	7.1	3/4
120H_ 3/8 X 1/8	3/8	1/8	1.33	33.8	0.19	4.8	7/8
120H_ 3/8 X 1/4	3/8	1/4	1.50	38.1	0.28	7.1	7/8
120H_ 3/8 X 3/8	3/8	3/8	1.51	38.4	0.38	9.6	7/8
120H_ 1/2 X 1/8	1/2	1/8	1.58	40.1	0.19	4.8	1 1/16
120H_ 1/2 X 1/4	1/2	1/4	1.76	44.7	0.28	7.1	1 1/16
120H_ 1/2 X 3/8	1/2	3/8	1.75	44.5	0.37	9.5	1 1/16
120H_ 1/2 X 1/2	1/2	1/2	1.94	49.3	0.47	11.9	1 1/16
120H_ 3/4 X 1/4	3/4	1/4	1.82	46.2	0.28	7.1	1 5/16
120H_ 3/4 X 3/8	3/4	3/8	1.82	46.2	0.37	9.5	1 5/16
120H_ 3/4 X 1/2	3/4	1/2	2.02	51.3	0.47	11.9	1 5/16
120H_ 3/4 X 3/4	3/4	3/4	2.02	51.3	0.62	15.8	1 5/16
120H_ 1 X 1/4	1	1/4	1.96	49.8	0.28	7.1	1 5/8
120H_ 1 X 1/2	1	1/2	2.16	54.9	0.47	11.9	1 5/8
120H_ 1 X 3/4	1	3/4	2.17	55.1	0.62	15.7	1 5/8
120H_ 1 X 1	1	1	2.28	57.9	0.88	22.4	1 5/8

120 HNR  
ADAPTER NPT TO BSPT

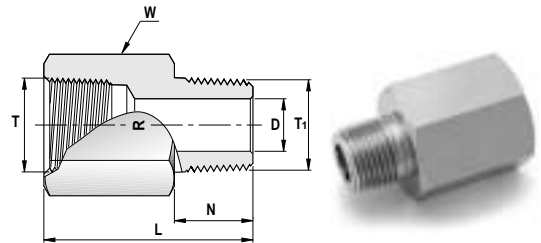

Ordering Information	T Female NPT Size	T1 Male BSPT ISO7/1, BS21 Size	L		N		D Min. Opening		W Hex. Flat in
			in	mm	in	mm	in	mm	
120HNR_ 1/8	1/8	1/8-28	1.09	27.7	0.38	9.7	0.19	4.8	9/16
120HNR_ 1/4	1/4	1/4-19	1.42	36.1	0.56	14.2	0.28	7.1	3/4
120HNR_ 3/8	3/8	3/8-19	1.50	38.1	0.56	14.2	0.38	9.6	7/8
120HNR_ 1/2	1/2	1/2-14	1.94	49.3	0.75	19.0	0.47	11.9	1 1/16
120HNR_ 3/4	3/4	3/4-14	2.02	51.3	0.75	19.0	0.62	15.8	1 5/16
120HNR_ 1	1	1-11	2.30	58.4	0.94	23.9	0.88	22.4	1 5/8

● Dimensions are for reference only, and are subject to change without notice.

120 HNG  
ADAPTER NPT TO BSPP

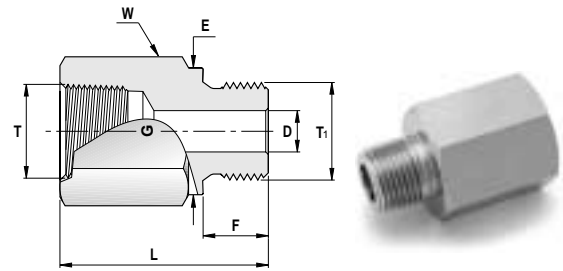

Ordering Information	T Female NPT Size	T1 Male BSPP ISO 228/1, BS 2779	L		F		E Dia.		D Min. Opening		W Hex. Flat in
			in	mm	in	mm	in	mm	in	mm	
			120HNG _ 1/8	1/8	1/8-28	0.99	25.1	0.28	7.1	0.54	
120HNG _ 1/4	1/4	1/4-19	1.32	33.5	0.44	11.2	0.70	18.0	0.23	5.8	3/4
120HNG _ 3/8	3/8	3/8-19	1.41	35.8	0.44	11.2	0.85	21.8	0.31	7.9	7/8
120HNG _ 1/2	1/2	1/2-14	1.74	44.2	0.56	14.2	1.02	26.0	0.47	11.9	1 1/16
120HNG _ 3/4	3/4	3/4-14	1.89	48.0	0.62	15.7	1.26	32.0	0.62	15.7	1 5/16
120HNG _ 1	1	1-11	2.10	53.3	0.72	18.3	1.53	39.0	0.78	19.8	1 5/8

120 HRN  
ADAPTER BSPT TO NPT

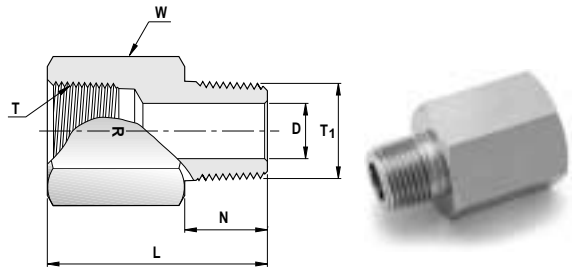

Ordering Information	T Female BSPT ISO 7/1, BS 21	T1 Male NPT Size	L		N		D Min. Opening		W Hex. Flat in
			in	mm	in	mm	in	mm	
			120HRN _ 1/4	1/4-19	1/4	1.43	36.3	0.56	
120HRN _ 3/8	3/8-19	3/8	1.51	38.4	0.56	14.2	0.38	9.6	7/8
120HRN _ 1/2	1/2-14	1/2	1.96	49.8	0.75	19.1	0.47	11.9	1 1/16

120 HGN  
GAUGE ADAPTER BSPP TO NPT

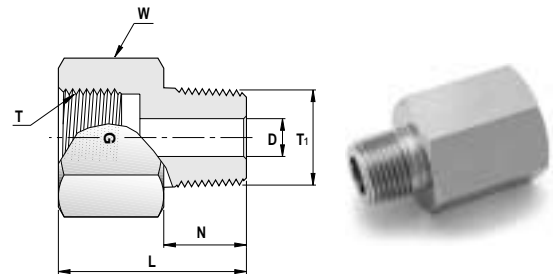

Ordering Information	T Female BSPP ISO 228/1, BS 2779 Size	T1 Male NPT Size	L		N		D Min. Opening		W Hex. Flat in
			in	mm	in	mm	in	mm	
			120HGN _ 1/4	1/4-19	1/4	1.08	27.4	0.56	
120HGN _ 3/8	3/8-19	3/8	1.27	32.3	0.56	14.2	0.26	6.6	15/16
120HGN _ 1/2	1/2-14	1/2	1.65	41.9	0.75	19.1	0.28	7.1	1 1/16

● Dimensions are for reference only, and are subject to change without notice.

121 H  
PIPE PLUG NPT

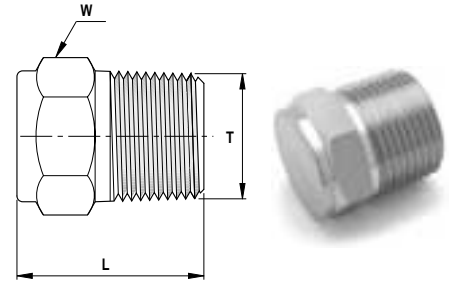

Ordering Information	T Male NPT Size	L		W Hex. Flat
		in	mm	
121H_ 1/16	1/16	0.75	19.0	5/16
121H_ 1/8	1/8	0.75	19.0	7/16
121H_ 1/4	1/4	0.96	24.4	9/16
121H_ 3/8	3/8	0.99	25.2	11/16
121H_ 1/2	1/2	1.21	30.7	7/8
121H_ 3/4	3/4	1.21	30.7	1 1/16
121H_ 1	1	1.50	38.1	1 3/8

122 H  
HEX NIPPLE

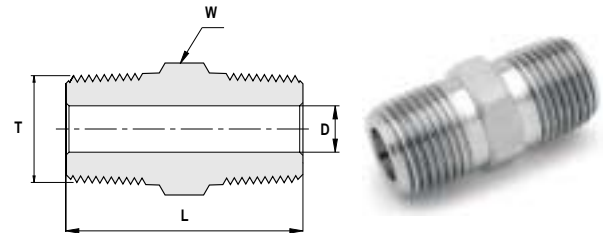

Ordering Information	T Male NPT Size	L		D Min. Opening		W Hex. Flat in
		in	mm	in	mm	
122H_ 1/16	1/16	1.01	25.7	0.12	3.0	5/16
122H_ 1/8	1/8	1.01	25.7	0.19	4.8	7/16
122H_ 1/4	1/4	1.40	35.6	0.28	7.1	9/16
122H_ 3/8	3/8	1.43	36.3	0.38	9.6	11/16
122H_ 1/2	1/2	1.84	46.7	0.47	11.9	7/8
122H_ 3/4	3/4	1.84	46.7	0.62	15.8	1 1/16
122H_ 1	1	2.32	58.9	0.88	22.4	1 3/8

122 HNR  
HEX NIPPLE NPT TO BSPT

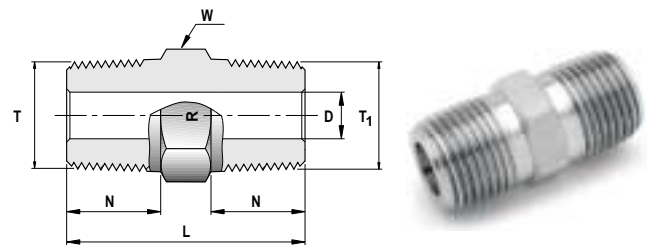

Ordering Information	T Male NPT Size	T1 Male BSPT ISO 7/1, BS21 Size	L		N		D Min. Opening		W Hex. Flat in
			in	mm	in	mm	in	mm	
122HNR_ 1/8	1/8	1/8-28	1.01	25.6	0.38	9.7	0.19	4.8	7/16
122HNR_ 1/4	1/4	1/4-19	1.40	35.6	0.56	14.2	0.28	7.1	9/16
122HNR_ 3/8	3/8	3/8-19	1.43	36.3	0.56	14.2	0.38	9.6	1 1/16
122HNR_ 1/2	1/2	1/2-14	1.84	46.7	0.75	19.0	0.47	11.9	7/8
122HNR_ 3/4	3/4	3/4-14	1.84	46.7	0.75	19.0	0.62	15.8	1 1/16
122HNR_ 1	1	1-11	2.32	58.9	0.94	23.9	0.88	22.4	1 3/8

● Dimensions are for reference only, and are subject to change without notice.

122 HNG  
HEX NIPPLE  
NPT TO BSPP

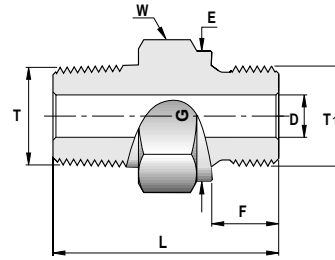

Ordering Information	T Male NPT Size	T1 Male BSPP ISO 228/1, BS 2779	L		F		E		D Min. Opening		W Hex. Flat
			in	mm	in	mm	in	mm	in	mm	in
122HNG _ 1/8	1/8	1/8-28	1.07	27.2	0.28	7.1	0.54	13.8	0.16	4.1	9/16
122HNG _ 1/4	1/4	1/4-19	1.44	36.3	0.44	11.2	0.71	18.0	0.23	5.8	3/4
122HNG _ 3/8	3/8	3/8-19	1.47	37.3	0.44	11.2	0.85	21.8	0.31	7.9	7/8
122HNG _ 1/2	1/2	1/2-14	1.78	45.2	0.56	14.2	1.02	26.0	0.47	11.9	1 1/16
122HNG _ 3/4	3/4	3/4-14	1.95	49.5	0.62	15.7	1.26	32.0	0.62	15.8	1 5/16
122HNG _ 1	1	1-11	2.26	57.4	0.72	18.3	1.53	39.0	0.78	19.8	1 5/8

123 H  
REDUCING NIPPLE

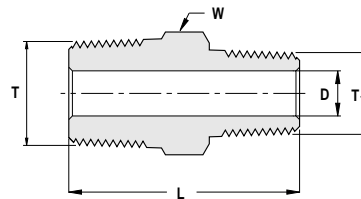

Ordering Information	T Male NPT Size	T1 Male NPT Size	L		D Min. Opening		W Hex. Flat
			in	mm	in	mm	in
123H _ 1/8 X 1/16	1/8	1/16	1.01	25.7	0.12	3.0	7/16
123H _ 1/4 X 1/8	1/4	1/8	1.22	31.0	0.19	4.8	9/16
123H _ 3/8 X 1/8	3/8	1/8	1.25	31.8	0.19	4.8	11/16
123H _ 3/8 X 1/4	3/8	1/4	1.43	36.3	0.28	7.1	11/16
123H _ 1/2 X 1/8	1/2	1/8	1.47	37.3	0.19	4.8	7/8
123H _ 1/2 X 1/4	1/2	1/4	1.65	41.9	0.28	7.1	7/8
123H _ 1/2 X 3/8	1/2	3/8	1.65	41.9	0.38	9.6	7/8
123H _ 3/4 X 1/4	3/4	1/4	1.65	41.9	0.28	7.1	1 1/16
123H _ 3/4 X 1/2	3/4	1/2	1.84	46.7	0.47	11.9	1 1/16
123H _ 1X 1/2	1	1/2	2.13	54.1	0.47	11.9	1 3/8
123H _ 1X 3/4	1	3/4	2.13	54.1	0.62	15.8	1 3/8

3600 H  
BRANCH TEE

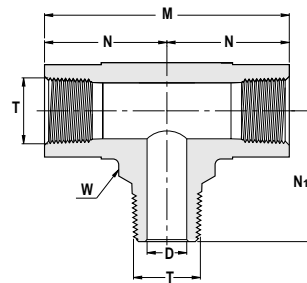

Ordering Information	T Male & Female NPT	M		N		N1		D Min. Opening		W Wrench Flat
		in	mm	in	mm	in	mm	in	mm	in
3600H _ 1/8	1/8	2.08	52.8	1.04	26.4	0.87	22.1	0.19	4.8	5/8
3600H _ 1/4	1/4	2.34	59.4	1.17	29.7	1.17	29.7	0.28	7.1	13/16
3600H _ 3/8	3/8	2.68	68.1	1.42	36.1	1.26	32.0	0.38	9.6	15/16
3600H _ 1/2	1/2	3.12	79.2	1.56	39.6	1.56	39.6	0.47	11.9	1 1/8

● Dimensions are for reference only, and are subject to change without notice.

3750 H  
STREET TEE

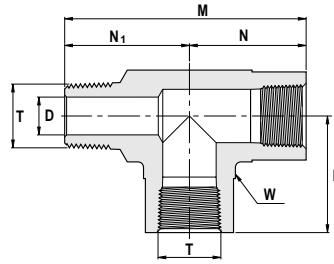

Ordering Information	T Male & Female NPT	M		N		N1		D Min. Opening		W Wrench Flat
		in	mm	in	mm	in	mm	in	mm	in
		3750H _ 1/8	1/8	1.91	48.5	1.04	26.4	0.87	22.1	0.19
3750H _ 1/4	1/4	2.34	59.4	1.17	29.7	1.17	29.7	0.28	7.1	13/16
3750H _ 3/8	3/8	2.68	68.1	1.42	36.1	1.26	32.0	0.38	9.6	15/16
3750H _ 1/2	1/2	3.12	79.2	1.56	39.6	1.56	39.6	0.47	11.9	1 1/8

130 HM  
MALE TO HOSE CONNECTOR

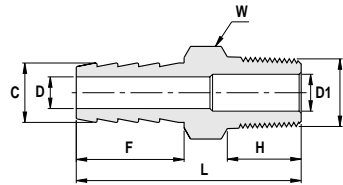

Ordering Information	Hose I.D.	T NPT Size	C		D		D1		F		H		L		W Hex. Flat
			in	mm	in	mm	in	mm	in	mm	in	mm	in	mm	in
			130HM _ 1/8 X 1/8	1/8	1/8	0.15	3.80	0.08	2.0	0.19	4.80	0.40	10.2	0.38	9.70
130HM _ 1/8 X 1/4	1/8	1/4	0.15	3.80	0.08	2.0	0.28	7.10	0.40	10.2	0.56	14.2	1.26	32.0	9/16
130HM _ 3/16 X 1/8	3/16	1/8	0.23	5.84	0.12	3.0	0.12	3.00	0.59	15.0	0.38	9.70	1.27	32.3	7/16
130HM _ 3/16 X 1/4	3/16	1/4	0.23	5.84	0.12	3.0	0.28	7.10	0.59	15.0	0.56	14.2	1.45	36.8	9/16
130HM _ 1/4 X 1/8	1/4	1/8	0.30	7.62	0.19	4.8	0.19	4.80	0.79	20.1	0.38	9.70	1.47	37.3	7/16
130HM _ 1/4 X 1/4	1/4	1/4	0.30	7.62	0.19	4.8	0.19	4.80	0.79	20.1	0.56	14.2	1.65	41.9	9/16
130HM _ 1/4 X 3/8	1/4	3/8	0.30	7.62	0.19	4.8	0.19	4.80	0.79	20.1	0.56	14.2	1.66	42.2	11/16
130HM _ 1/4 X 1/2	1/4	1/2	0.30	7.62	0.19	4.8	0.47	11.9	0.79	20.1	0.75	19.0	1.85	47.0	7/8
130HM _ 5/16 X 1/8	5/16	1/8	0.38	9.65	0.19	4.8	0.19	4.80	0.87	22.1	0.38	9.70	1.55	39.4	7/16
130HM _ 5/16 X 1/4	5/16	1/4	0.38	9.65	0.19	4.8	0.19	4.80	0.87	22.1	0.56	14.2	1.73	43.9	9/16
130HM _ 5/16 X 3/8	5/16	3/8	0.38	9.65	0.19	4.8	0.19	4.80	0.87	22.1	0.56	14.2	1.74	44.2	11/16
130HM _ 5/16 X 1/2	5/16	1/2	0.38	9.65	0.19	4.8	0.47	11.9	0.87	22.1	0.75	19.0	1.96	49.8	7/8
130HM _ 3/8 X 1/4	3/8	1/4	0.45	11.43	0.30	7.6	0.30	7.60	0.87	22.1	0.56	14.2	1.73	43.9	9/16
130HM _ 3/8 X 3/8	3/8	3/8	0.45	11.43	0.30	7.6	0.30	7.60	0.87	22.1	0.56	14.2	1.74	44.2	11/16
130HM _ 3/8 X 1/2	3/8	1/2	0.45	11.43	0.30	7.6	0.30	7.60	0.87	22.1	0.75	19.0	1.96	49.8	7/8
130HM _ 1/2 X 1/4	1/2	1/4	0.60	15.24	0.37	9.5	0.28	7.10	0.94	23.8	0.56	14.2	1.80	45.7	11/16
130HM _ 1/2 X 3/8	1/2	3/8	0.60	15.24	0.37	9.5	0.37	9.50	0.94	23.8	0.56	14.2	1.81	46.0	11/16
130HM _ 1/2 X 1/2	1/2	1/2	0.60	15.24	0.37	9.5	0.37	9.50	0.94	23.8	0.75	19.0	2.03	51.6	7/8
130HM _ 5/8 X 1/2	5/8	1/2	0.75	19.10	0.47	11.9	0.47	11.9	0.98	24.9	0.75	19.0	2.07	52.6	1 1/16
130HM _ 5/8 X 3/4	5/8	3/4	0.75	19.10	0.50	12.7	0.63	16.0	0.98	24.9	0.75	19.0	2.07	52.6	1 1/16
130HM _ 3/4 X 1/2	3/4	1/2	0.90	22.86	0.63	16.0	0.47	11.9	1.05	26.7	0.75	19.0	2.14	54.4	1 1/16
130HM _ 3/4 X 3/4	3/4	3/4	0.90	22.86	0.63	16.0	0.63	16.0	1.05	26.7	0.75	19.0	2.14	54.4	1 1/16
130HM _ 3/4 X 1	3/4	1	0.90	22.86	0.63	16.0	0.88	22.4	1.05	26.7	0.94	23.9	2.43	61.7	1 3/8
130HM _ 1 X 3/4	1	3/4	1.2	30.48	0.88	22.4	0.63	16.0	1.19	30.2	0.75	19.0	2.38	60.5	1 3/8
130HM _ 1 X 1	1	1	1.2	30.48	0.88	22.4	0.88	22.4	1.19	30.2	0.94	23.9	2.57	65.3	1 3/8

• Dimensions are for reference only, and are subject to change without notice.

130 HF  
FEMALE HOSE CONNECTOR

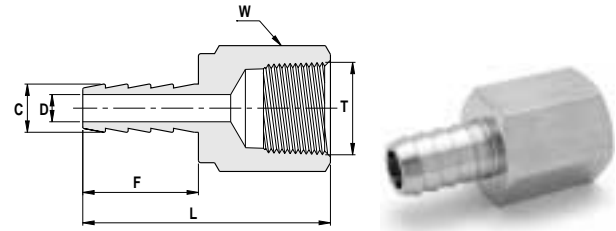

Ordering Information	Hose I.D.	T NPT Size	C		D Min. Opening		F		L Min. Opening		W Hex. Flat in
			in	mm	in	mm	in	mm	in	mm	
			130HF _ 1/8 X 1/8	1/8	1/8	0.15	3.80	0.08	2.00	0.40	
130HF _ 1/8 X 1/4	1/8	1/4	0.15	3.80	0.08	2.00	0.40	10.2	1.26	32.0	3/4
130HF _ 3/16 X 1/8	3/16	1/8	0.23	5.84	0.12	3.00	0.59	15.0	1.29	32.8	9/16
130HF _ 3/16 X 1/4	3/16	1/4	0.23	5.84	0.12	3.00	0.59	15.0	1.44	36.6	3/4
130HF _ 1/4 X 1/8	1/4	1/8	0.30	7.62	0.19	4.80	0.79	20.1	1.47	37.3	9/16
130HF _ 1/4 X 1/4	1/4	1/4	0.30	7.62	0.19	4.80	0.79	20.1	1.64	41.7	3/4
130HF _ 1/4 X 3/8	1/4	3/8	0.30	7.62	0.19	4.80	0.79	20.1	1.71	43.4	7/8
130HF _ 5/16 X 1/4	5/16	1/4	0.38	9.65	0.19	4.80	0.87	22.1	1.73	43.9	3/4
130HF _ 5/16 X 3/8	5/16	3/8	0.38	9.65	0.19	4.80	0.87	22.1	1.82	46.2	7/8
130HF _ 3/8 X 1/4	3/8	1/4	0.45	11.43	0.30	7.60	0.87	22.1	1.69	42.9	3/4
130HF _ 3/8 X 3/8	3/8	3/8	0.45	11.43	0.30	7.60	0.87	22.1	1.78	45.2	7/8
130HF _ 3/8 X 1/2	3/8	1/2	0.45	11.43	0.30	7.60	0.87	22.1	2.03	51.6	1 1/16
130HF _ 1/2 X 1/2	1/2	1/2	0.60	15.24	0.38	9.70	0.94	23.9	2.13	54.1	1 1/16

130 LT  
TUBE TO  
HOSE CONNECTOR

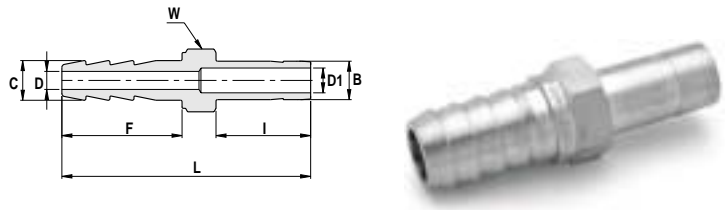

Ordering Information	Hose I.D.	B Tube Size	C		D		D1		F		I		L		W Hex. Flat in
			in	mm	in	mm	in	mm	in	mm	in	mm			
			130LT _ 1/8 X 1/8	1/8	1/8	0.15	3.80	0.08	2.00	0.09	2.30	0.40	10.2	0.53	
130LT _ 1/8 X 1/4	1/8	1/4	0.15	3.80	0.08	2.00	0.19	4.80	0.40	10.2	0.62	15.7	1.44	36.6	3/8
130LT _ 1/4 X 1/4	1/4	1/4	0.30	7.62	0.19	4.80	0.19	4.80	0.79	20.1	0.62	15.7	1.83	46.5	7/16
130LT _ 1/4 X 3/8	1/4	3/8	0.30	7.62	0.19	4.80	0.28	7.10	0.79	20.1	0.69	17.5	1.90	48.3	7/16
130LT _ 1/4 X 6 MM	1/4	6mm	0.30	7.62	0.19	4.80	0.18	4.60	0.79	20.1	0.62	15.7	1.86	47.2	7/16
130LT _ 5/16 X 1/4	5/16	1/4	0.37	9.40	0.19	4.80	0.19	4.80	0.87	22.1	0.62	15.7	1.91	48.5	7/16
130LT _ 3/8 X 3/8	3/8	3/8	0.45	11.43	0.30	7.60	0.28	7.10	0.87	22.1	0.69	17.5	1.98	50.3	9/16
130LT _ 3/8 X 1/2	3/8	1/2	0.45	11.43	0.30	7.60	0.39	9.90	0.87	22.1	0.91	23.1	2.20	55.9	5/8
130LT _ 1/2 X 3/8	1/2	3/8	0.60	15.24	0.38	9.70	0.28	7.10	0.94	23.9	0.69	17.5	2.05	52.1	11/16
130LT _ 1/2 X 1/2	1/2	1/2	0.60	15.24	0.38	9.70	0.39	9.90	0.94	23.9	0.91	23.1	2.27	57.7	11/16
130LT _ 3/4 X 3/4	3/4	3/4	0.90	22.86	0.63	16.0	0.59	15.0	1.05	26.7	0.97	24.6	2.44	62.0	1 1/16

● Dimensions are for reference only, and are subject to change without notice.